

Sling Hook EGK

For use with Grade 100 or Grade 80 chain. Sling hook with clevis connector.

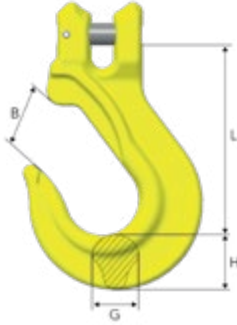

Stock No.	Code	WLL (lb)*	L	B	G	H	Weight (lb)
Z100915	EGK-6-10	3306	3.39	1.14	0.67	0.79	0.88
Z100918	EGK-7-10	4500	3.74	1.26	0.67	0.87	1.10
Z100938	EGK-8-10	5700	3.74	1.26	0.67	0.91	1.10
Z100942	EGK-10-10	8800	4.76	1.61	0.91	1.22	2.20
Z100946	EGK-13-10	15000	5.71	1.93	1.10	1.50	4.41
Z100950	EGK-16-10	22600	6.69	2.40	1.42	1.81	8.38
Z101138	EGK-20-10	35300	8.23	2.80	1.65	2.36	16.09

4:1 Design Factor. Fulfills requirements in: EN 1677:2008 (WLL +25%), ASTM A952/A952M and AS 3776:2015.

Sling Hook EGKN

For use with Grade 100 or Grade 80 chain. Sling hook with latch.

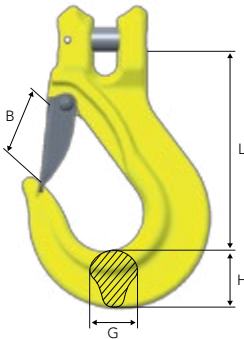

Stock No.	Code	WLL (lb)*	L	B	G	H	Weight (lb)
B14460	EGKN-6-10	3306	3.39	0.98	0.67	0.79	0.88
Z100843	EGKN-7-10	4500	3.74	1.06	0.67	0.91	1.10
B14461	EGKN-8-10	5700	3.74	1.10	0.67	0.91	1.10
B14462	EGKN-10-10	8800	4.76	1.38	0.91	1.22	2.43
B14463	EGKN-13-10	15000	5.71	1.65	1.10	1.50	4.85
B14464	EGKN-16-10	22600	6.69	2.09	1.42	1.81	8.82
Z101127	EGKN-20-10	35300	8.23	2.56	1.65	2.36	16.76

4:1 Design Factor. Fulfills requirements in: EN 1677:2008 (WLL +25%), ASTM A952/A952M and AS 3776:2015.

Coupling Link GF – stain proof

High strength stainless steel.

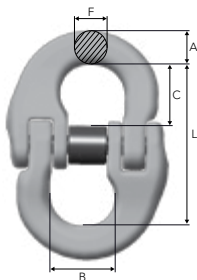

Stock No.	Code	WLL (lb)	For chain dim.	L	B	F	A	C	Weight (lb)
B80202	GF-10-8 SP	7100	3/8"	2.68	0.98	0.43	0.51	1.02	0.66
B80203	GF-13-8 SP	12000	1/2"	3.50	1.18	0.59	0.63	1.30	1.54
B80204	GF-16-8 SP	18000	5/8"	4.13	1.42	0.75	0.79	1.57	2.65

4:1 Design Factor

Coupling Link G HDG

Hot-dip galvanized for marine environments.

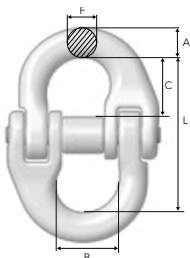

Stock No.	Code	WLL (lb)	L	B	F	A	C	Weight (lb)
ZG100821	G-6-8 HDG	2500	1.77	0.59	0.28	0.31	0.67	0.22
ZG100822	G-8-8 HDG	4500	2.20	0.71	0.35	0.43	0.87	0.44
ZG100823	G-10-8 HDG	7100	2.68	0.98	0.43	0.51	1.02	0.66
ZG100824	G-13-8 HDG	12000	3.50	1.18	0.59	0.63	1.30	1.54
ZG100825	G-16-8 HDG	18000	4	1.42	0.75	0.79	1.57	2.65

4:1 Design Factor